

# RPM – 36 , 40 , 58

Fuel pressure regulator



## Description

The RPM series of regulators are designed for either direct mounting within the fuel rail, or in-line mounting using the CS038 regulator housing.

The regulator comprises a sealing valve joined to an elastic membrane which by means of a compression spring compensates the pressure within the regulator, hence, adjusting the fuel flow.

The body and cover are made from stainless steel, as are all internal components in contact with fuel, with the exception of the membrane which is a reinforced vulcanised rubber.



## Dimensions

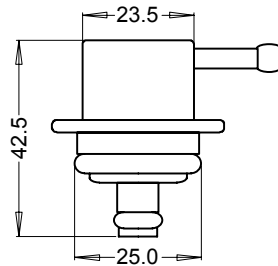

## Technical Data

Weight ..... 37 g  
Flow range ..... 5 > 300 l/h  
Max vibration ..... 30 g  
Temperature range ..... 0 > 100 °c  
Filter mesh ..... 150 µm  
Fuel ..... commercial

Pressure .....	RPM36	RPM40	RPM58	
Nominal pressure.....	250	300	350	kPa
@ flow rate .....	40	40	80	l/h
methanol resistant .....	no	no	no	

## Ordering information

Part No.	Description	Order Code
RPM 36	2.5bar regulator	219244330501
RPM 40	3.0 bar regulator	219244340501
RPM 58	3.5 bar regulator	230016052057

MM Competition Systems Ltd Hyjuniper, Long Lane Shaw, Berkshire, RG14 2TA England	For further details please contact	Tel: +44 (0)8707 444666 Fax: +44 (0)8707 444888 www.mmcompsys.com mail@mmcompsys.com
---	------------------------------------	---